

Moodle and Aula

SOCIAL LEARNING IN MOODLE



- Moodle is an example of learning management system that involves online learning for more than 10 years now*
- The Moodle **Socialwall** will transform your Moodle course into a social learning platform*
- This includes a familiar post interface, timeline of posts, filtering of the timeline, and integration with Moodle's activities and resources.*

SOCIALWALL

Tutors can:

- make different kinds of posts***
- attach files and URLs to posts***
- comment on posts and reply to comments***

Students may:

- make standard posts***
- attach resources (files or links) to posts***
- comment on posts and reply to comments***

OVERVIEW OF AULA

What is Aula?

- ***As a “Learning Experience Platform” Aula offers educators and learners the opportunity to approach their modules in the more social and conversational way.***

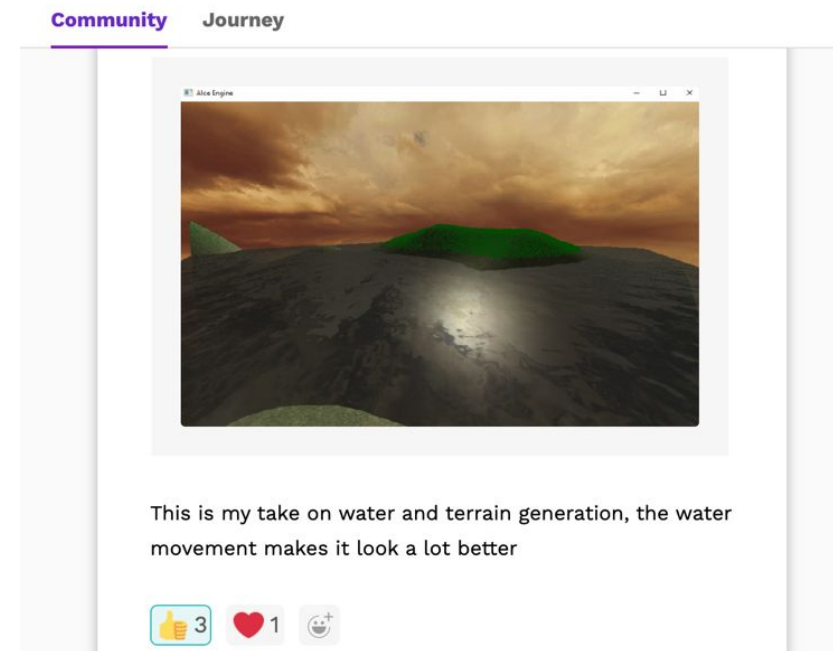

SOCIAL FEATURES

- Enable intuitive communication through course-wide posts and instant messaging***
- Interact through posts, comments, messages and reactions (emojis).***
- Make announcements and send reminders.***
- Native iOS and Android mobile apps***

BENEFITS

- ☐ Saves academics' time by streamlining communication and reducing task duplication.***
- ☐ Substantially increases student engagement compared to traditional alternatives***
- ☐ Makes collaboration and cross-departmental work easier by connecting all students.***
- ☐ Supports widening participation through spaces that are accessible from anywhere (PC, Android, iPhone/iPad).***

HOW IT DIFFERS FROM OTHER ONLINE LEARNING PLATFORM



- ❑ ***No Learning Management System (LMS) and fewer emails.***
- ❑ ***More engagement supported by mobile learning***

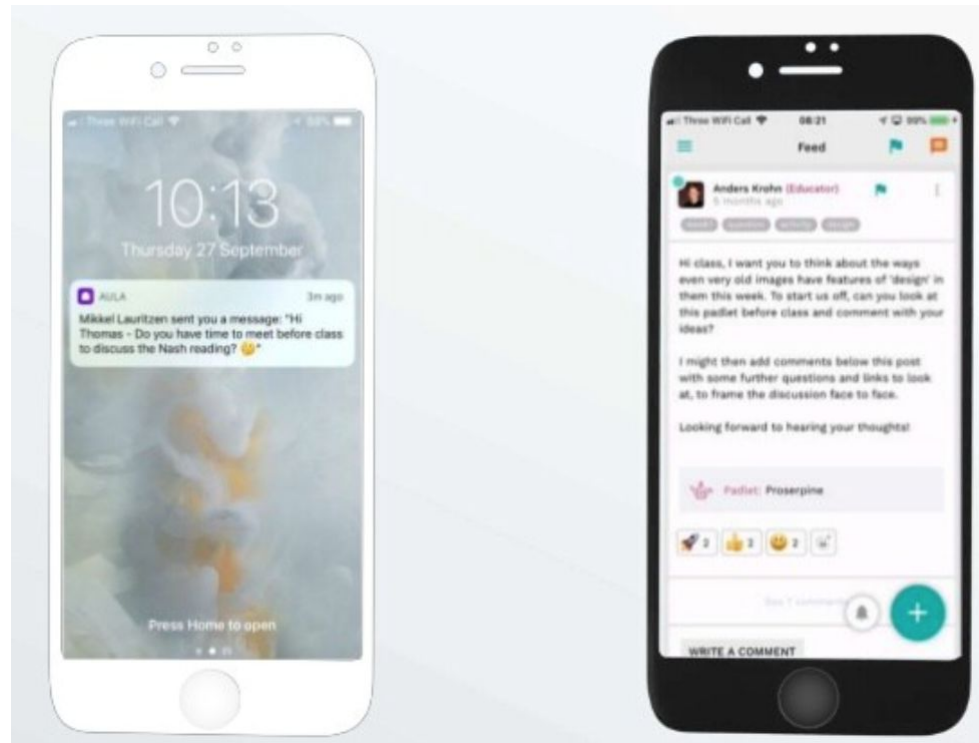

PILOT STUDY



Pilot study at Ravensbourne University London.

6 programmes, 280 first-year students

1,736 40 195 227

New Messages

New Reactions

New Comments

New Posts

North-Star Metric - Student only

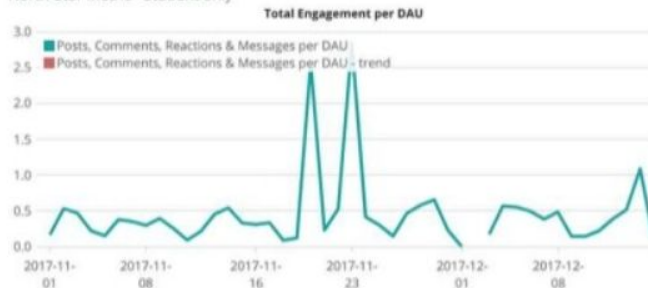

DAU/MAU

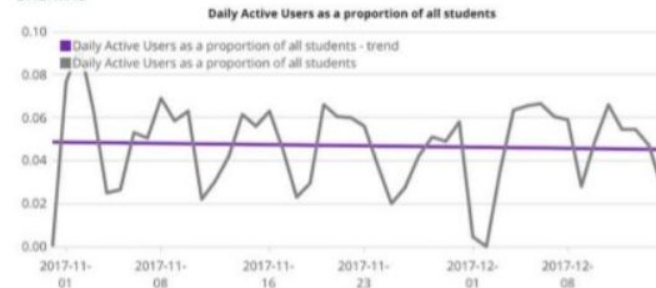

Engagement Summary

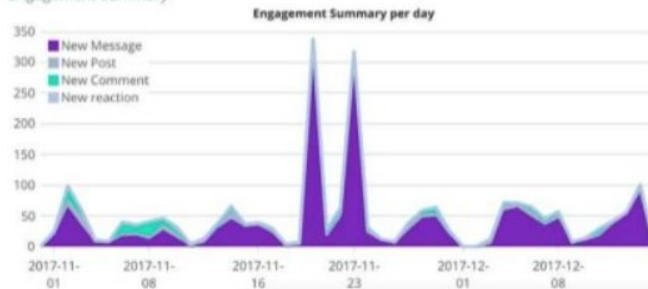

Device [Unique sessions]

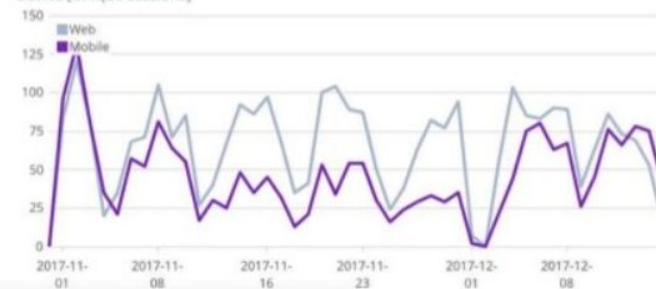

Ravensbourne pilot, engagement analytics, ~1.5 months, 280 first year students

STUDENT FEEDBACKS

A red, irregular speech bubble with a pointed tail pointing towards the bottom left.

80 % of students say that Aula helps them **feel part of a community of staff and students.**

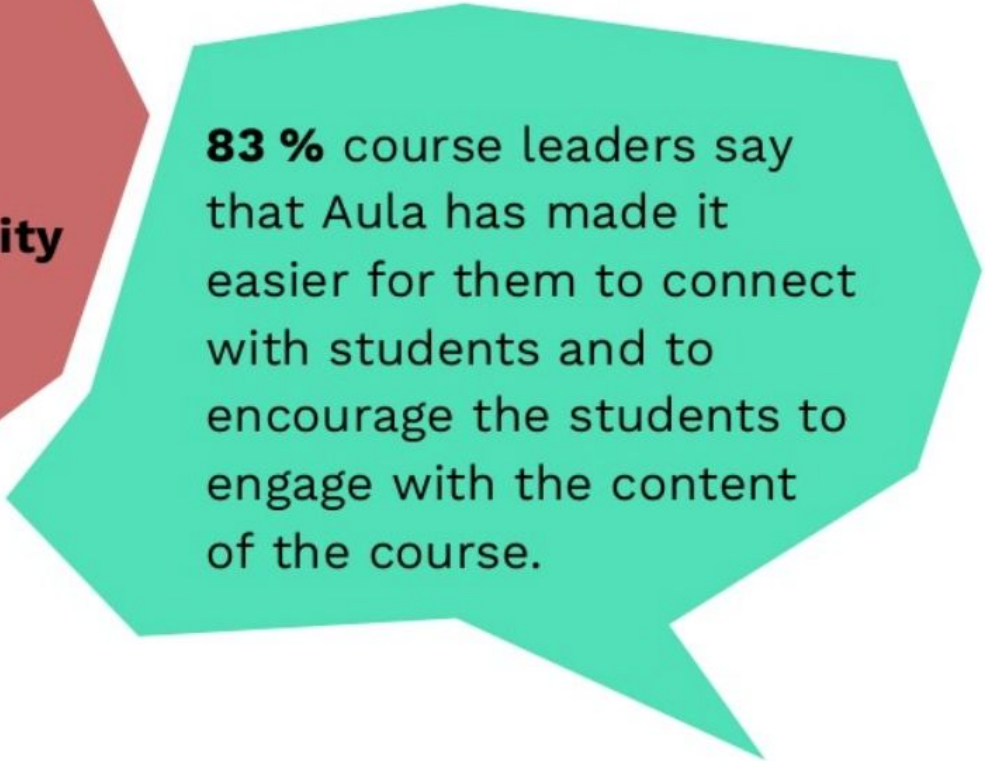
A teal, irregular speech bubble with a pointed tail pointing towards the bottom right.

83 % course leaders say that Aula has made it easier for them to connect with students and to encourage the students to engage with the content of the course.

TEACHING MATERIALS IN AULA



The screenshot shows the VRACE interface with several annotations:

- User management**: Points to the user icon in the top navigation bar.
- Module management**: Points to the 'Materials' tab in the top navigation bar.
- Engagement statistics**: Points to the 'Engagement' tab in the top navigation bar.
- Assessment section**: Points to the 'Assessments' tab in the top navigation bar.
- Module info**: Points to the 'Materials' section on the left sidebar.
- Weekly teaching materials**: Points to the 'Assessment' section in the left sidebar, which is highlighted with a green box.

The interface includes the following elements:

- Top Navigation Bar**: Community, Journey (selected), User icon, Materials, Assignments, Engagement, Educator area.
- Left Sidebar**:
 - Materials**: Welcome and Intr..., Getting Help, Health and Wellb..., Module Esse...
 - Assessment**: Week 1 - Ray ..., Week 2 - Ray..., Week 3 - Opt..., Week 4 - Sha..., Week 5 - Vul..., Week 6 - Ter...
- Main Content Area**:
 - Engagement statistics**: My progress and the progress of others in this module/course tell me.
 - Assessment section**: Apply theoretical mathematical concepts to the creation of computer graphics algorithms that will support advanced computer games activities.
 - Design a rendering engine, taking account of relevant methods and techniques
 - Select and utilise advanced computer graphics algorithms appropriate for real-time applicationsThe module will combine online learning and oncampus tutorials.
 - The online learning experience will be active, social and applied, developing your knowledge and building out key skill through weekly solo and group activities and a live seminar session. Each week you will: